

Utah Arts & Museums Public Art Program
Requests Qualifications for the Richfield Regional Center



Request for Qualifications from artists or artist teams interested in creating site-specific artwork(s) for the Richfield Regional Center.

DEADLINE FOR MATERIALS: October 20, 2025

RICHFIELD REGIONAL CENTER SERVICES

This facility will house regional offices for four state agencies: the Department of Health and Human Services, Utah Division of Motor Vehicles, the Department of Public Safety, and the Department of Workforce Services. Consolidating these services will assist with efficiently serving beautiful Sevier County and benefits our state agencies through combining shared resources.

These four state agencies each play a crucial role in the safety, stability, and wellbeing of Sevier County's population, which is often geographically separated from many essential services. The Department of Health and Human Services was established through the consolidation of the Utah Department of Health and the Utah Department of Human Services in July 2022. This reorganization intends to streamline the delivery of critical services to Utah's population. The Utah Division of Motor Vehicles, a division of the Utah State Tax Commission, provides Utahns with the resources necessary to safely and legally operate a vehicle. The Utah Department of Public Safety operates, among others, the Driver License Division, the Division of Emergency Management, and the Highway Safety Office. The Department of Workforce Services assists Utah jobseekers and employers across all demographics, and was the first state agency in the nation to combine employment and public assistance programs.

RICHFIELD, UTAH

Located in Sevier County, Richfield is the largest city in southern-central Utah and serves as a resource base for surrounding residents and traveling tourists alike. Historically the area's economy was heavily agricultural, but has expanded to include trade, manufacturing, mining, and retail services as Richfield has grown into an economic hub for Central Utah. Richfield is also home to regional campuses for Snow College and Utah State University.

The Richfield area is known for a number of distinctive historical, cultural, and environmental landmarks. Located just south of the city is the Fremont Indian State Park and Museum, which spotlights the largest known Fremont culture site. Also nearby are the scenic Mystic Hot Springs, Fishlake National Forest, and Pando, the world's largest living organism. As both a key stop on the way through Utah's scenic "Panoramaland" and as an important connection point for local residents, Richfield holds a vital place in Central Utah's way of life.



Downtown Richfield, Utah by Ken Lund, 2006.

COMMITTEE STATEMENT

It is the intention of the Art Selection Committee to commission site-specific artwork from Utah artists, or artists residing in the surrounding states of Nevada, Wyoming, Idaho, Colorado, New Mexico, or Arizona. The committee is interested in exterior sculptural or installation work that pays tribute to rich and varied significance of the Richfield region. This subject may include natural wonders such as the iconic red rock and sandstone formations of the area, cultural and historical themes like Fremont Culture sites or Richfield's more recent history, including agriculture and mining. All proposed artwork should center Richfield and enrich the experience for both visitors and residents of the area.

The Richfield Regional Center's layout includes a passthrough corridor that connects to a public walkway on College Ave, and will become a common footpath to the Snow College Richfield Campus. There are a few notable areas of interest for art inclusion throughout the footprint of the building. Artworks may be proposed for locations along the front east entrance of the building, or throughout the gathering spaces and bike path of the west, freeway-facing side of the building.

The artwork's subject matter and content must be appropriate for public exhibition and not contain advertising, religious references, sexual or violent content, or convey political partisanship.



Fremont State Park Hoodoos, by Murray Foubister. 2011. CC BY-SA 2.0

BUDGET

\$104,000 is available for the project. This project budget is for **all related expenses** of this public art commission, including (but not limited to) artist fees, fabrication, support structures, insurance, shipping, travel, lighting, installation, documentation, etc.

ELIGIBILITY

Professional artists and artist teams **residing in Utah, Arizona, Colorado, Nevada, Wyoming, New Mexico, or Idaho** are eligible for this commission. Artists residing in Utah will receive additional weight in the review process. Applicants must have a U.S. Tax ID Number (SSN, EIN, ITIN, or other). Art Selection Committee members and staff of Utah Arts & Museums and AJC Architects are not eligible to apply for this commission. All art selection committee members will declare any conflict of interest and recuse themselves from the vote when reviewing artist applications.

SUBMISSION INSTRUCTIONS

Interested artists may submit applications online. Register at www.callforentry.org and follow the directions for registration and submitting material for the Richfield Regional Center Public Art Request for Qualifications. The application process will prompt you for all necessary documents and information. This includes up to 10 images and/or up to two movie files of previous work, a CV or résumé, and a Statement of Interest explaining your interest in the project and how your work might relate to the project. Utah Arts & Museums will not be responsible for delayed applications or damaged electronic files. Faxed or emailed applications cannot be accepted.

To request an accommodation for a disability, please complete an accommodation form at least two weeks in advance of the **October 20th** deadline. Accommodation forms can be found at artsandmuseums.utah.gov/accessibility.

DEADLINE

Complete application packages must be RECEIVED by
October 20, 2025 by 11:59 p.m. MT.

SELECTION PROCESS AND SCHEDULE

The selection committee will review all properly submitted qualifications, from which a short list of semi-finalists will be selected. Semi-finalists will be asked to present a full proposal to the

committee on **January 12, 2026** to include concept, budget, and timeline. All semi-finalists will be awarded an honorarium to help defray the costs of the development of the proposal. The honorarium will be applied toward the commission amount for the artist(s) awarded the commission(s.) Utah Arts & Museums will not be responsible for applications delayed or lost. The Richfield Regional Center Art Selection Committee reserves the right to withhold the award of a commission or re-release the call for entries.

Schedule:

October 20, 11:59 p.m. MDT | Deadline for receipt of preliminary materials

November 6, 2025 | Committee review and finalist artist notification

January 15, 2026 | Finalists interviews and presentations

Summer 2027 | Artwork completed

Fall 2027 | Project substantial completion

ARTIST SELECTION COMMITTEE

Rob Robinson	Project Manager, Division of Facilities Construction & Mgmt
Chris Hall	Principal Architect, AJC Architects
Mindi Busk	Division of Motor Vehicles
Julie Nielson	Department of Health and Human Services
Mindy Thurstan	Department of Health and Human Services
Jourdan Watts	Department of Health and Human Services
Darren Johnson	Department of Workforce Services
Alexa Schear	Department of Workforce Services
Brittany Elmer	Department of Public Safety
Sharon Albrecht	Department of Public Safety
Prescott McCarthy	Visual Arts Specialist

Please do not contact committee members directly. If you have any questions about this or other projects, information is available at: artsandmuseums.utah.gov/publicart/ Or contact: Hannah Nielsen at hnielsen@utah.gov

See next page for Site Renderings.
Images courtesy AJC Architects



DFCM - Richfield
Exterior Renderings and Floor Plan Updates
New - Rendering - East Perspective





DFCM - Richfield
 Exterior Renderings and Floor Plan Updates
 New - Rendering - West Perspective



DFCM - Richfield
 Exterior Renderings and Floor Plan Updates
 New - Rendering - West Perspective





DFCM - Richfield
 Exterior Renderings and Floor Plan Updates
 New - Rendering - East Elevation Entry



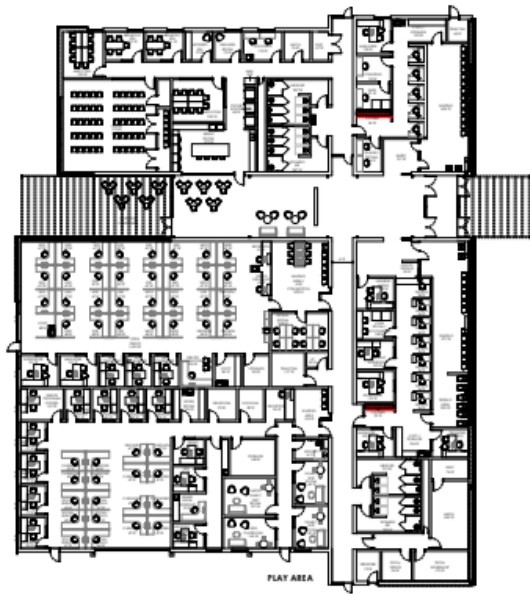

DFCM - Richfield
 Exterior Renderings and Floor Plan Updates
 New - Floor Plan

