

Utah Arts & Museums Public Art Program  
Requests Artists Qualifications  
for the  
Utah Valley University Performing Arts Center - Orem, Utah



Request for qualifications from artists and/or artist teams interested in creating site specific artwork(s) for the Performing Arts Center on the campus of Utah Valley University in Orem, Utah.

**DEADLINE FOR MATERIALS: January 30, 2017**

## THE PERFORMING ARTS CENTER

Utah Valley University's Performing Arts Complex will serve as the new home for the School of Arts, and Utah County's premier performance venue. The robust building program contains an 892 seat proscenium theater, 501 seat concert hall, 176 seat dance performance studio, 150 seat choral ensemble space / recital hall, and large instrument ensemble space with scoring stage designed to accommodate a 70 piece orchestra. The facility will also accommodate faculty offices, conference rooms, individual practice rooms, dressing rooms, rehearsal classrooms, and a special guest event space.

The major performance venues are organized and accessed along a central spine which connects two major entries into the facility. The grand lobby and main entry plaza to the north, and the south entry and plaza to the south. The main spine connecting these two entries displays art and projection surfaces for digital art and instruction, includes student collaborative zones, and lounge seating, all contributing to an immersive cultural and engaged learning environment. Entries leading to each of the major performance venues are clad with warm wood tones and elegant back painted glass panels.

A 35-foot tall glass curtain wall at the building's main entry, and clerestory glazing along length of the spine provides dramatic daylighting throughout these activated common spaces. In the evening, the facility becomes a lantern which displays the grand lobby and stair, art, and community activity which is an inviting view to patrons approaching for their evening event. The interior space dramatic backdrop to the multi-level exterior entry plaza.



### Exterior Plaza and Site

The Main Entry Plaza is composed of three major terraces which descend gradually towards the building, following the natural grade of the site. As a result, this transition between levels, forms three distinctly unique outdoor zones.

- The Upper Terrace serves as the receiving area for the parking area and welcomes users with a vehicular drop-off, pathway connection to the parking area, and seating zone which overlooks the sequential terraces below. This is the threshold as the user transitions from parking to the performing arts environment.
- The Main Terrace is the largest of the three and is positioned five feet lower than the neighboring upper terrace. It is designed to provide greater flexibility for events, outdoor classroom sessions, and clear access to the building's main lobby. Strategically located trees, raised planters, seating and landscape are positioned to form a clear path and sightlines to the building entry, as well as provide intimate seating zones around the center of this terrace. The main terrace overlooks and provides access to the lower terrace through ramps, stairs and amphitheater style seating.
- The Lower Terrace is located five feet below the main terrace. An amphitheater style seating arrangement looks onto an outdoor stage which is bordered on two glass facades which provide visual connection to the adjacent Dance studio and grand lobby. To further this interior/exterior connection, the amphitheater steps pass through the grand lobby's glass façade to form stairs on the lobby floor glass facades.

## Massing

The building massing can be described as a simple arrangement of explicit volumes, each housing one piece of the facility's complex program. The functionality and performance criteria of each space directly influence the length / width / height of each volume which gives them each their own distinct shape. The location of each volume is driven by a network of complex existing conditions onsite, including grade, adjacencies to other buildings, and access corridors for back of house services, and patron experience.



## Materials and Details

Utah Valley University has a long standing tradition of expressively using concrete, brick, metal panel, and glass on campus buildings. Aesthetically, this creates the appearance of a continuous campus fabric which also lends itself to the fact that all buildings are connected through a network of interior circulation routes and or concourses. Each building's exterior is still unique due to the internal program's influence on the building exterior. Likewise, the new PAC will celebrate this material tradition, but the uniqueness of the design relies on the building's complex program, and defines how the exterior materials are organized on the façade. Each volume is entirely clad in its own material, either brick or metal panel. Special attention to punched opening window details was given to provide additional depth and articulation to the façade. Irregular placement of punched openings and articulated aluminum fins create a unique façade texture which was inspired by the movement of music and dance.



### Project concept drivers

In the early stages of design, the project team collected a series of terms and images influenced by each of the departments, this served as the conceptual drivers for the overall project. The team settled on:

Dance: Dynamics, Space, and Form / Music: Rhythm, Volume, and Harmony

Theater: Collaborative, Immersive, Engaged, and Story.



## UTAH VALLEY UNIVERSITY AND THE SURROUNDING LANDSCAPE

Utah Valley University is located 45 minutes south of Salt Lake City. Bordered on the west by Utah Lake and on the east by the Wasatch Mountain Range, UVU is the largest institution of higher learning in the state. Founded in 1941, UVU's expansion has mirrored the population growth of the valley. From a vocational school, to a technical college, then community college, followed by a state college, UVU was given university status in 2008. Almost 35,000 students are enrolled at UVU, which includes 85 associate/certificate programs, 65 bachelor degrees and now 8 master degrees. The hallmark of UVU is its focus on engaged learning. It is classified as a "community engaged" institution by the Carnegie Foundation. UVU's service area encompasses communities in Utah, Wasatch and Summit Counties. Utah County alone has a population of over half a million people.

Utah Valley extends from the city of Alpine on the north to Nephi on the south, a span of almost 60 miles. Mount Timpanogos is the crown peak that overlooks the University at an elevation of over 11,700 feet. The valley floor sits at about 4,500 feet. Utah Lake is a remnant of Lake Bonneville, which covered much of the mountain west in the Pleistocene Epoch. The Provo River is home to fly fishing and feeds into the lake. Winter sports, hiking, mountain biking, and water recreation abound in the area. Sundance Resort is about 20 minutes east of campus in Provo Canyon. Each summer, UVU and Sundance collaborate on a musical production performed at the Sundance Amphitheatre. Past productions include *The Sound of Music*, *Fiddler on the Roof*, and *Seven Brides for Seven Brothers*.

## THE UVU SCHOOL OF THE ARTS

The School of the Arts is home to four departments with over 1,700 students who have selected majors in: Art & Design, Dance, Music and Theatrical Arts for the Stage & Screen. Each program features both specialized professional degrees, as well as broader, more general degrees. There is an emphasis on interdisciplinary collaboration among students and programs within the arts, which the new building will enhance and facilitate. The School of the Arts strives to hone imagination, creativity and innovation among its students, as evidenced by the mission statement below.

The Mission Statement of the School of the Arts is: The UVU School of the Arts attracts and retains those with sufficient talent and passion for a career in the Arts and challenges them to hone imagination, creativity, and innovation as they secure the knowledge, skills, and experiences vital to their success. It enlivens, enhances, and enriches UVU and its varied communities through scholarly activities, public exhibits and performances, participation in or with the Arts, and classes about the Arts.

## COMMITTEE STATEMENT

The Performing Arts Center will be an iconic building that serves as the gateway to the east side of campus. It will become a gathering place and hub for the arts in the valley. The building will feature over 40 events per year. In addition to engaging with UVU students on campus, there are also plans for outreach programs for adults, teens and children within the community to come and learn from both UVU students and faculty. The dance part of the facility is adjacent to the main plaza, with large windows that invite the viewer into the performance space. Significant digital infrastructure will exist within the building for large digital displays.

The Committee hopes that the modern, elegant and timeless beauty of the building can be complemented with innovative, engaging, immersive and interactive art. The art could serve as a secondary “performance” within the building. There is a sense of vertical rhythm to the architecture that the artist may consider in conceptualizing an art dialogue with the facility.

The following areas have been identified as potential siting for public artwork / dialogue / engagement and the Committee will be open other sites as suggested by interested artists:

1. The main atrium.
2. Many areas outside of the building have been identified as potential sites for artistic engagement.
3. The west side of the building, to create emphasis or focus that would intrigue those on the west side of campus as they look/travel towards the east.
4. The beautiful façade includes 30-foot windows with stunning views of Mount Timpanogos and spacious plazas. The Committee would ask that any proposed installation for this site not overly obstruct the dramatic views.

## BUDGET

**\$193,000** is available for all related expenses of this Public Art commission(s) including (but not limited to) artist fees, fabrication, insurance, shipping, travel, installation, documentation, etc.

## ELIGIBILITY

Resident American or legal resident artists / artist teams are encouraged to apply. Utah artists are encouraged to apply. Art Selection Committee members, staff of Utah Arts & Museums and Method Studio are not eligible to apply for this commission. All Art Selection Committee members will declare any conflict of interest and recuse themselves from the vote when reviewing artist applications.

## SUBMISSION OPTIONS, INSTRUCTIONS AND REQUIRED MATERIALS

Interested artists may submit applications online or by compact disc/DVD. The deadline is the same for both methods and is not a postmark deadline. Please do not include supplemental materials beyond the requirements listed below. All applications must include the following:

### ON-LINE METHOD:

- Register at [www.callforentry.org](http://www.callforentry.org) and follow the directions for registration and submitting material for this Public Art Request for Qualifications

If the artist's work cannot be documented well with still image you may submit movie files via the "Compact Disc or DVD Method" listed below. Movie files cannot be submitted via the online method.

### COMPACT DISC METHOD:

- A PC compatible CD labeled with applicant's name, and contact information containing:
- A letter of interest of not more than two typewritten pages in pdf format. This letter should include the artist's reasons for interest in this project in particular. In doing so, the artist should also describe how his/her work and/or experience relates to the project.
- Up to six (6) images maximum of previous site-specific public work. All images must be in JPEG format, 1920 pixels maximum on the longest side, 72 dpi, with compression settings resulting in the best image quality under 2MB file size. The image files should be named so that the list sorts in the order of the image listing.
- A pdf document identifying each image to include title, year, medium, dimensions.
- A professional resume in pdf format

If the work cannot be documented well with still images a DVD (of no more than 3 minutes) may be submitted as documentation of artist's projects. Please note only one media (movie file or images) can be presented to the committee per artist in this preliminary phase.

If the artist wishes the material returned, an addressed and stamped envelope of ample size and postage for return of the CD or DVD should be included. Material that is not accompanied by a stamped envelope will not be returned.

Utah Arts & Museums will not be responsible for applications delayed or lost in transit. While all reasonable care will be taken in the handling of materials, neither the Utah Division of Arts & Museums nor the UVU Performing Arts Center Selection Committee will be liable for late, lost or damaged materials or electronic files. Faxed or e-mailed applications cannot be accepted.

UVU Performing Arts Center Selection Committee reserves the right to withhold the award of a commission or re-release the call for entries.

## DEADLINE

Complete application packages must be RECEIVED on or before **January 30, 2017** by 5 p.m. (THIS IS NOT A POSTMARK DEADLINE.) All supporting materials must accompany application.

Please send, deliver or courier applications to:

Jim Glenn, Utah Public Art Program - Attention: UVU Performing Arts  
Utah Arts & Museums - 300 S Rio Grande - Salt Lake City, UT 84101

## SELECTION PROCESS AND SCHEDULE

The Selection Committee will review all material properly submitted. Finalists will be selected from the first phase of applicants submitting qualifications. Selection of the commissioned artist(s) will be based on proposals presented to the Selection Committee on April 10, 2017. The committee may commission more than one artist.

Once a finalist is selected we will work to provide as much information and access as possible to assist in the artist's research while developing their proposal.

An honorarium will be extended to the finalists to assist with the costs associated with the preparation of proposals and travel. This honorarium will be applied toward the commission amount for the artist(s) awarded the commission.

Schedule:

January 30, 2017 - Deadline for receipt of preliminary materials

February 13, 2017 - Committee Review

April 10, 2017 - Finalists interviews

December 2018 – Building construction substantial completion

## ARTIST SELECTION COMMITTEE

Clint Bunnell	Utah Division of Facilities Construction & Management
Blair Buswell	Artist and Utah Division of Arts & Museums Board of Directors
Daniel Fairbanks	Artist and Dean, College of Science & Health
Jim Godfrey	Associate Dean, School of the Arts
Lisa Hagen	Associate Professor, Theater
Melissa Hempel	Director / Curator-Woodbury Art Museum
Stephen Purdy	UVU Theater / Lecturer
Joe Smith	Method Studio Architecture
Nancy Steele-Makasci	Artist and Fine Arts Coordinator, Associate Professor of Art
Frank Young	Associate Vice President – Facilities Planning

If you have any questions about this or other projects information is available at: [www.utahpublicart.org](http://www.utahpublicart.org)

Or contact: Jim Glenn at 801-245-7271 or e-mail at: [jglenn@utah.gov](mailto:jglenn@utah.gov)

Felicia Baca at 801-245-7272 or [fbaca@utah.gov](mailto:fbaca@utah.gov)

All images courtesy Method Studio Architecture





UTAH VALLEY UNIVERSITY

PERFORMING ARTS COMPLEX

METHOD STUDIO INC.

## PERFORMING ARTS COMPLEX

SCHEMATIC DESIGN  
FLOOR PLAN: MAIN LEVEL

- THEATRE
- MUSIC
- DANCE
- ENSEMBLE
- SERVICES
- TEACHING/PRACTICE

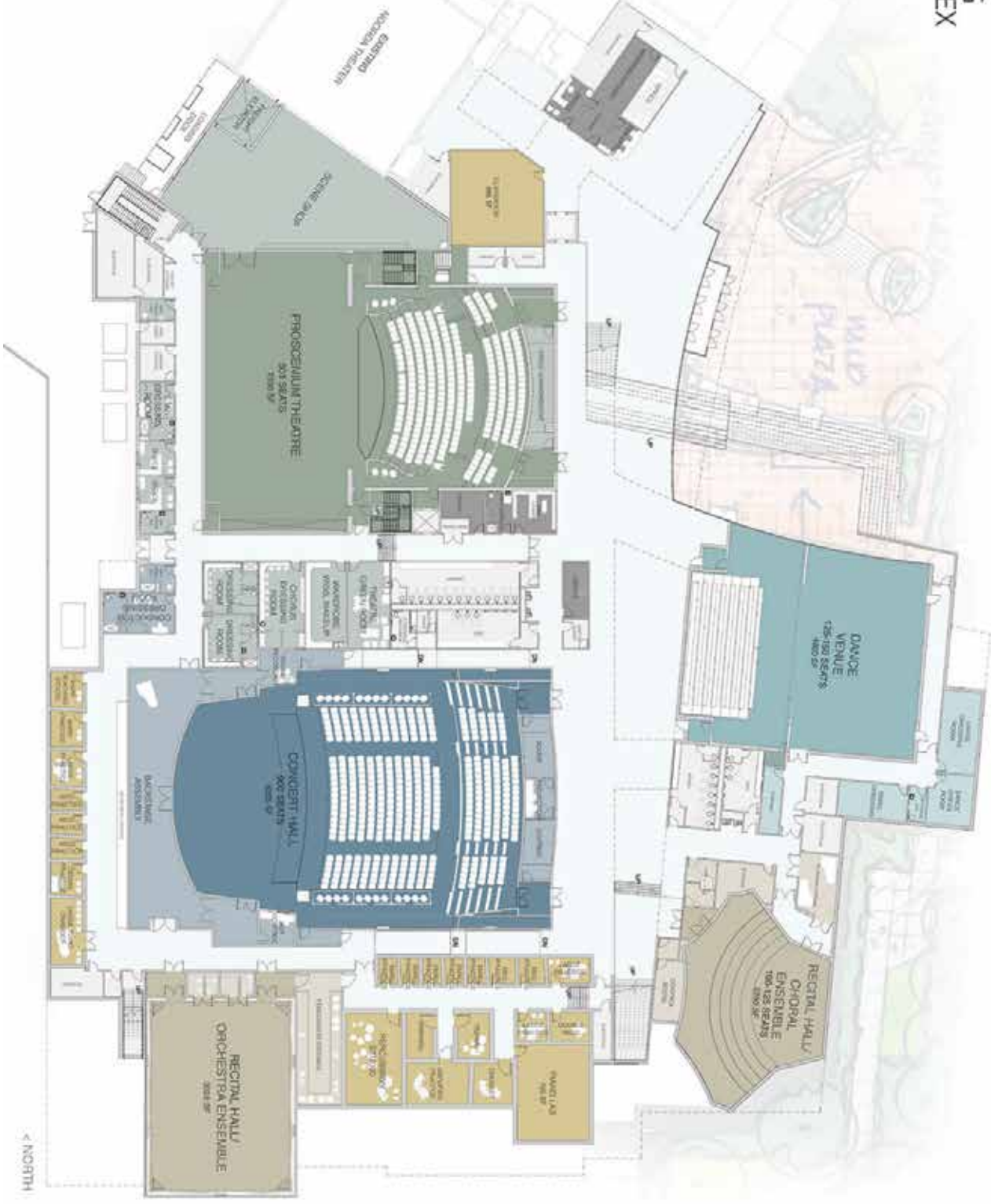



# PERFORMING ARTS COMPLEX

SCHEMATIC DESIGN  
FLOOR PLAN: SECOND LEVEL

- PROSCENIUM
- CONCERT
- DANCE HALL
- MUSIC TEACHING/OFFICES
- THEATRE OFFICES/STUDIOS
- SHARED ZONES
- SERVICES

